

# PLAN 1

www.invarion.com

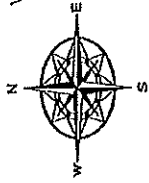

Date: May 6, 2016 Author: Natalie May - 604-396-9164 Universal Flagging: 170-8061 Loughheed Hwy Burnaby, BC V5A 1W9  
 Office: 604-444-3732 Dwg: 001

**Comments:**

Golder Associates  
 Mark Newman  
 604-353-6464

City of Chilliwack  
 -Job location - Yale Rd & Alexander Ave  
 -Closure description - Curb Lane Closure & Road Closed  
 -Tentative date - TBA  
 -Job description - Bore Hole Testing



**Advanced Warning Sign distances may be shortened due to Urban block length**

**Legend**

- Work Area
- Tubular
- Crew Working symbol C-004
- road closed ahead W20-3
- Flagger Ahead C-001-1
- Right Lane Closed symbol C-130-R
- Sign Stand
- flagger
- Arrowboard (Single)

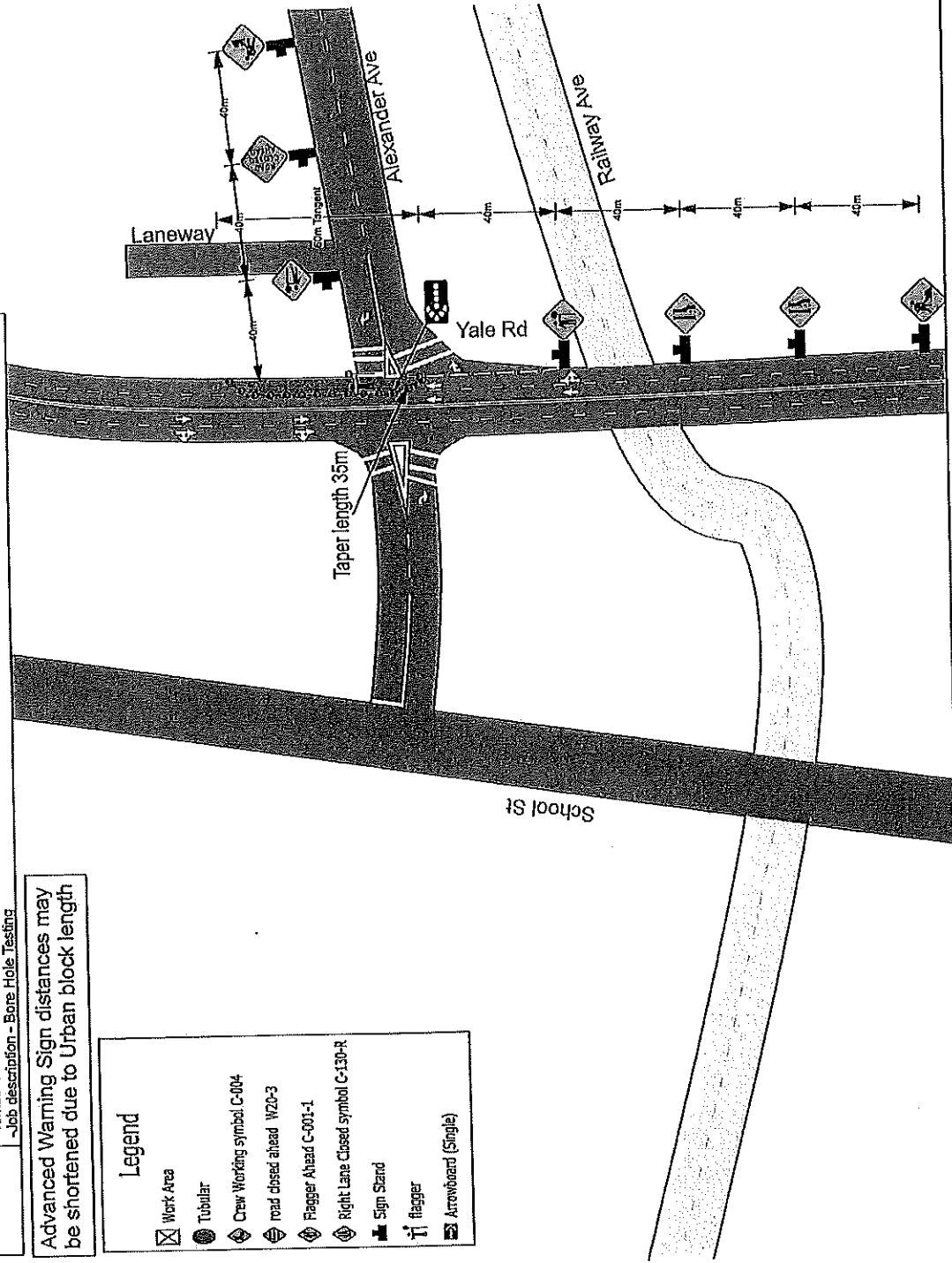

PLAN 2.

www.invarion.com

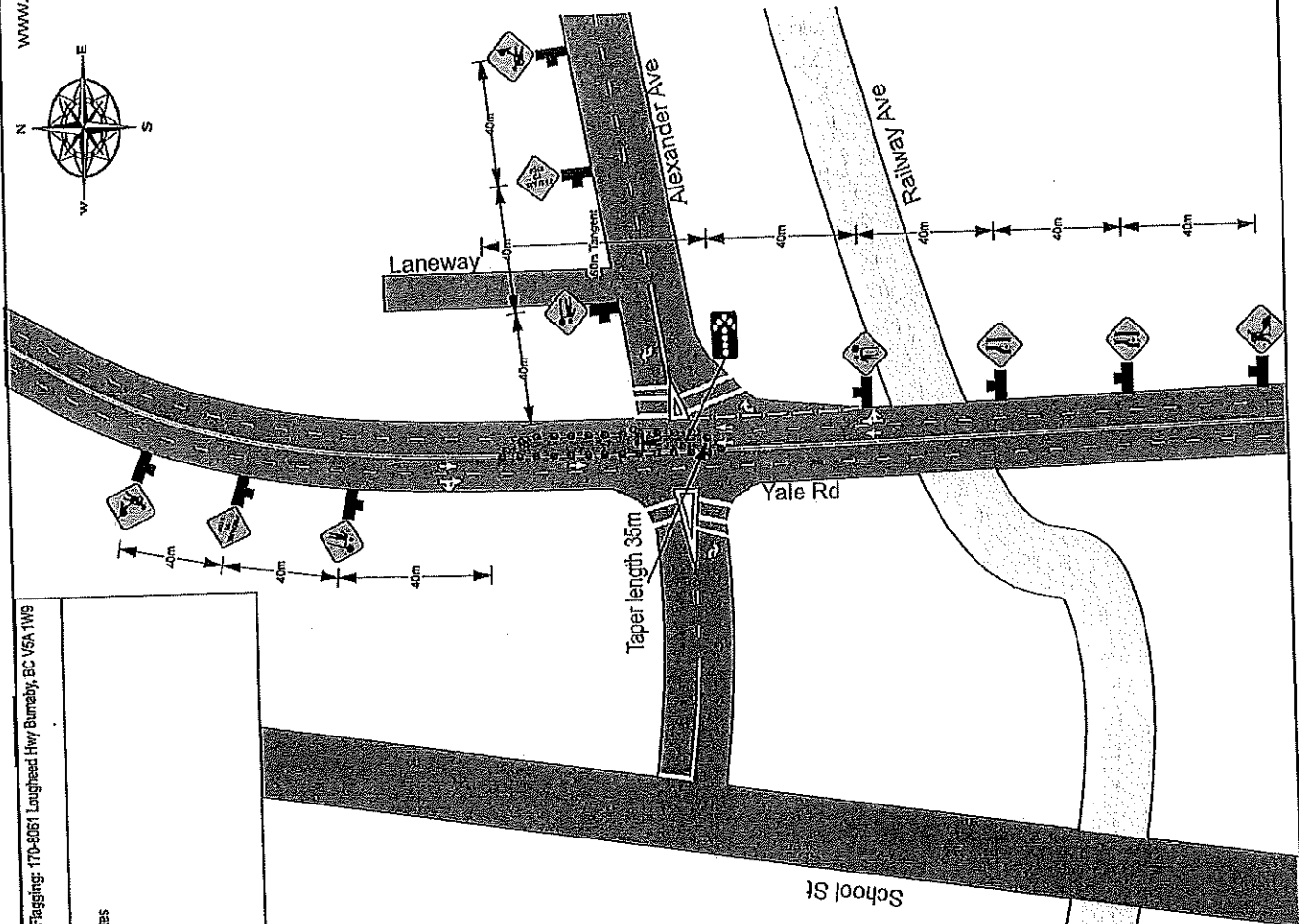
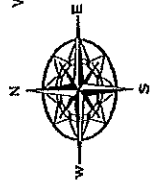

Date: May 6, 2016 Author: Natalia May - 604-386-9164 Universal Flagging - 170-8061 Lougheed Hwy Burnaby, BC V5A 1W9  
 Office: 604-444-3732 Draw: 001

Comments:  
 Golden Associates  
 Mark Newman  
 604-353-9464

City of Chilliwack  
 Job location - Yale Rd & Alexander Ave  
 Closure description - Center Lane Closure - North Bound  
 Tentative date - TBA  
 Job description - Bore Hole Testing



Advanced Warning Sign distances may be shortened due to Urban block length

Legend

- Work Area
- Tubular
- Crew Working symbol C-004
- Flagger Ahead C-001-1
- Sign Stand
- flagger
- Arrowboard (Single)

PLAN 3.

www.invation.com

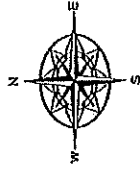

Date: May 6, 2016 Author: Natalie May - 504-386-6164 Universal Flagging - 170-8081 Lougheed Hwy Burnaby, BC V5A 1W5  
 Office: 504-444-3732 Dwg: 001

Comments:

Golder Associates  
 Mark Newman  
 604-353-6464

City of Chilliwack  
 -Job location - Yale Rd & Alexander Rd  
 -Closure description - Hard Road closure - Westbound  
 -Terminative date - TBA  
 -Job description - Bone Hole Testing

Advanced Warning Sign distances may be shortened due to Urban block length

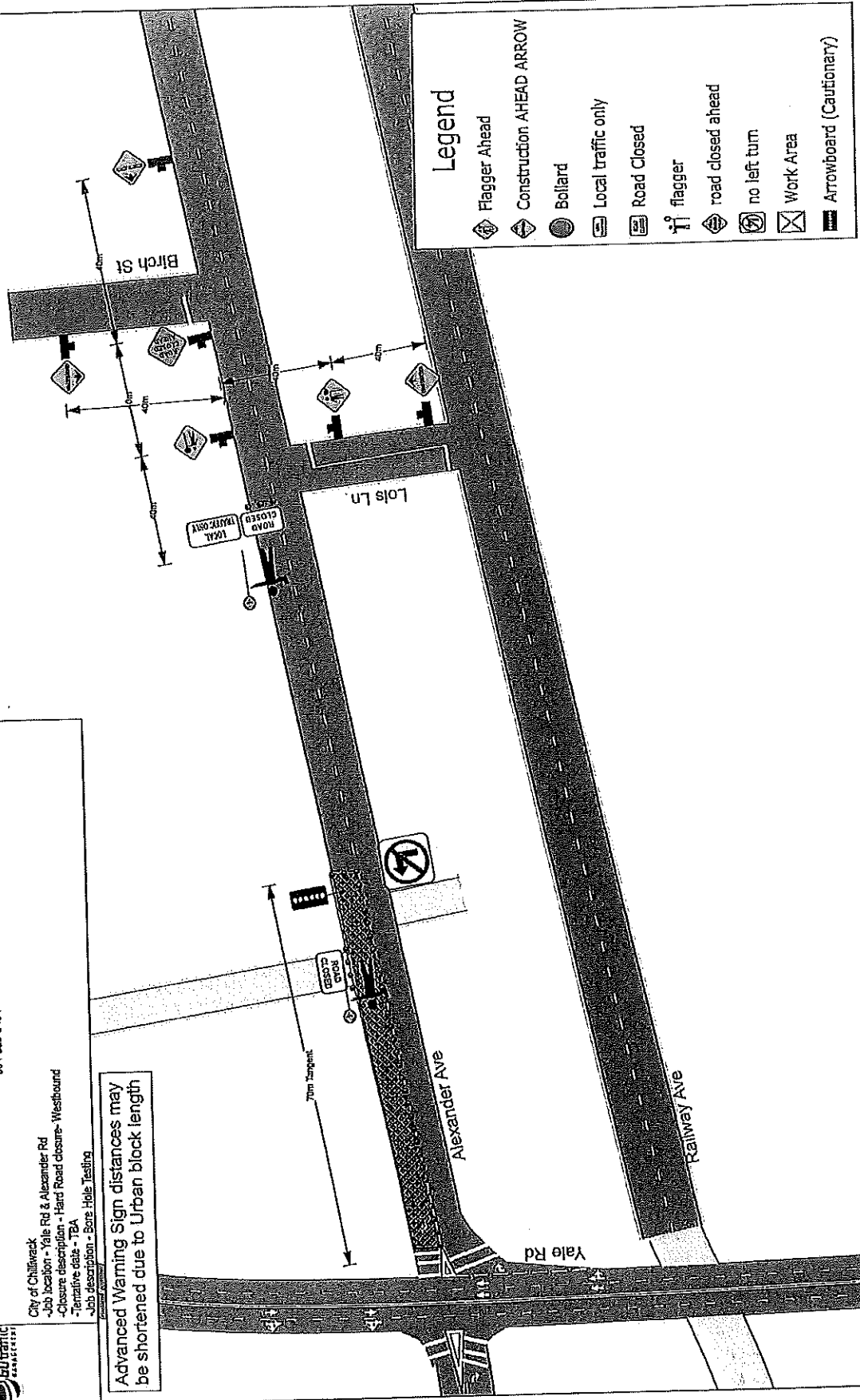

Legend	
	Flagger Ahead
	Construction AHEAD ARROW
	Bollard
	Local traffic only
	Road Closed
	flagger
	road closed ahead
	no left turn
	Work Area
	Arrowboard (Cautionary)

# PLAN 4

www.invanion.com

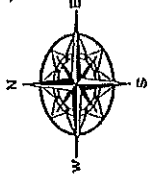

Date: May 6, 2016 Author: Natalie May - 604-395-9164 Universal Flagging: 170-8061 Loughhead Hwy Burnaby, BC V5A 1W9  
 Office: 604-444-3732 Dwg: 001

**Comments:**

Golder Associates  
 Mark Newman  
 604-353-6454

City of Chilliwack  
 -Job location - Yale Rd & Alexander Rd  
 -Closure description - North bound right turn lane closure  
 -Alternative date - TBA  
 -Job description - Bore Hole Testing

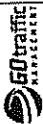

Advanced Warning Sign distances may be shortened due to Urban block length

**Legend**

- Crew Working symbol C-004
- Sign Stand
- Arrowboard (Warning)
- Work Area
- Bollard
- HLWD
- high visibility flag target
- no right turn RS-11
- Traffic Pattern Changed
- Flagger Ahead
- no left turn

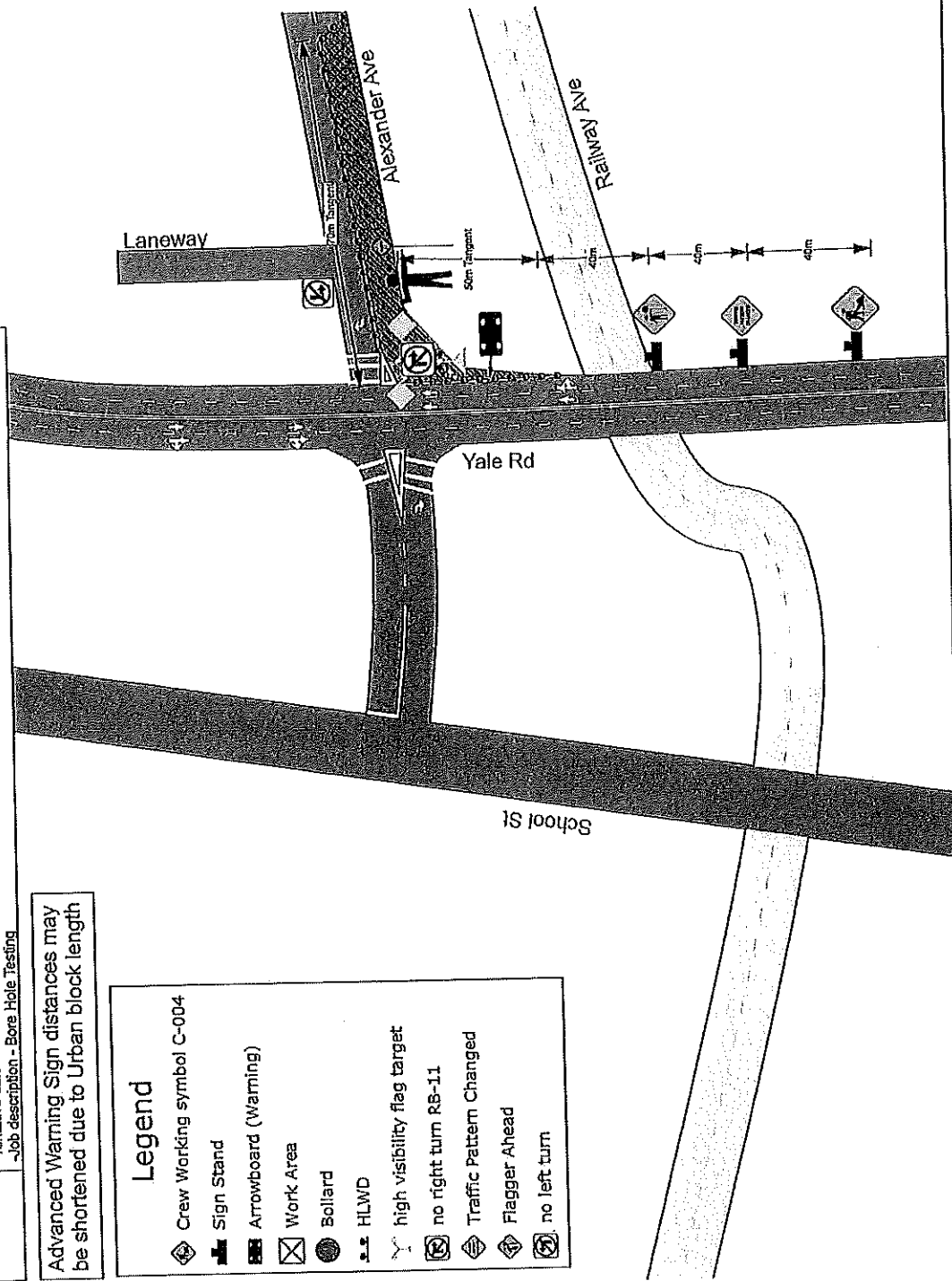

PLAN 5

www.invarion.com

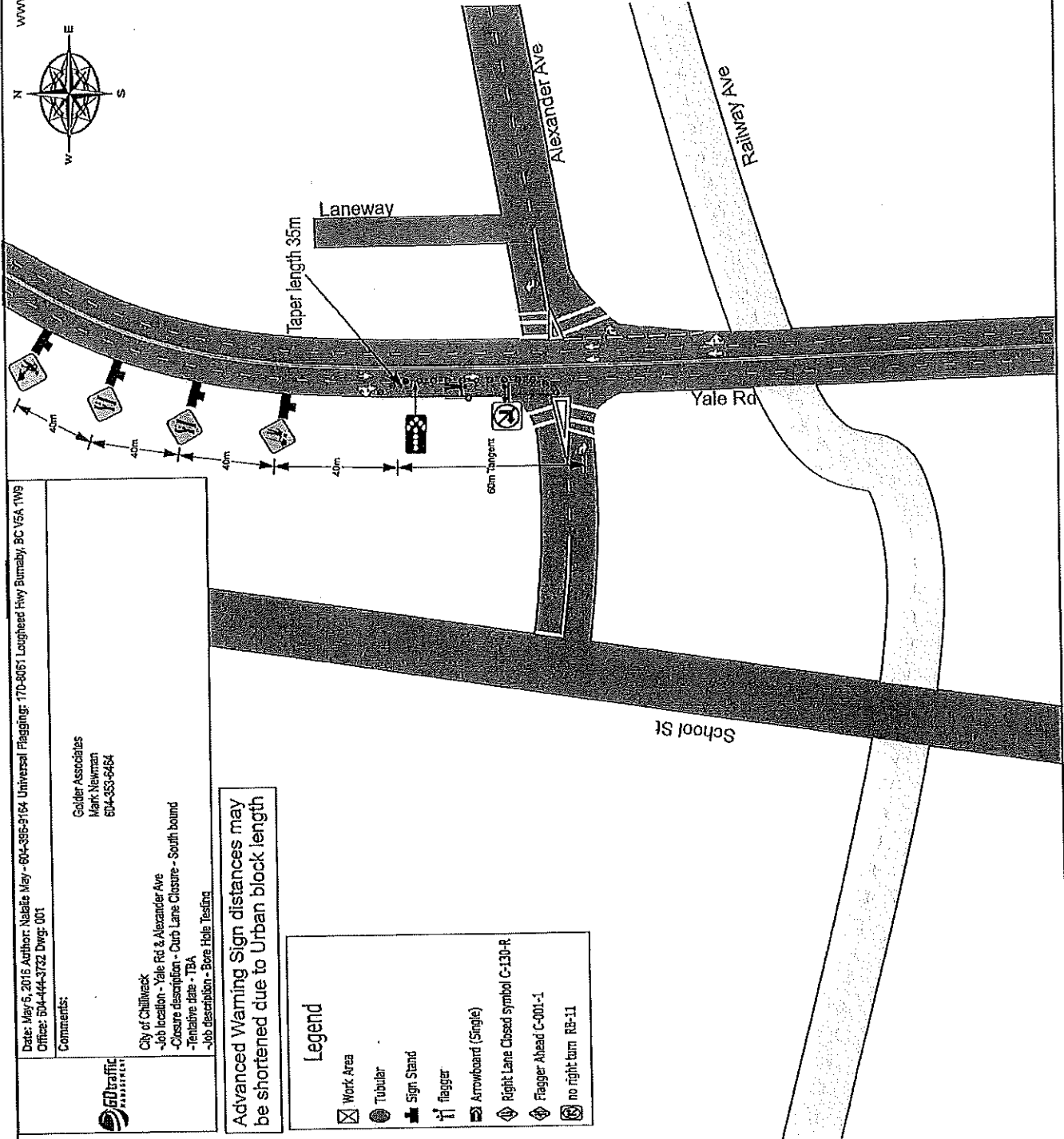
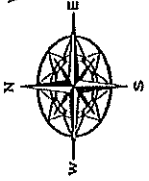

Date: May 6, 2016 Author: Nadia May - 604-985-9164 Universal Flagging: 170-8061 Loughhead Hwy Burnaby, BC V5A 1W9  
 Office: 504-444-3732 Dwg: 001

Comments:

Golder Associates  
 Mark Newman  
 604-353-6464

City of Chilliwack  
 -Job location - Yale Rd & Alexander Ave  
 -Closure description - Curb Lane Closure - South bound  
 -Tentative date - TBA  
 -Job description - Bore Hole Testing

Advanced Warning Sign distances may be shortened due to Urban block length

Legend

- Work Area
- Tubular
- Sign Stand
- flagger
- Arrowboard (Single)
- Right Lane Closed Symbol C-130-R
- Flagger Ahead C-401-1
- no right turn BB-11



# PLAN 6

www.invarion.com

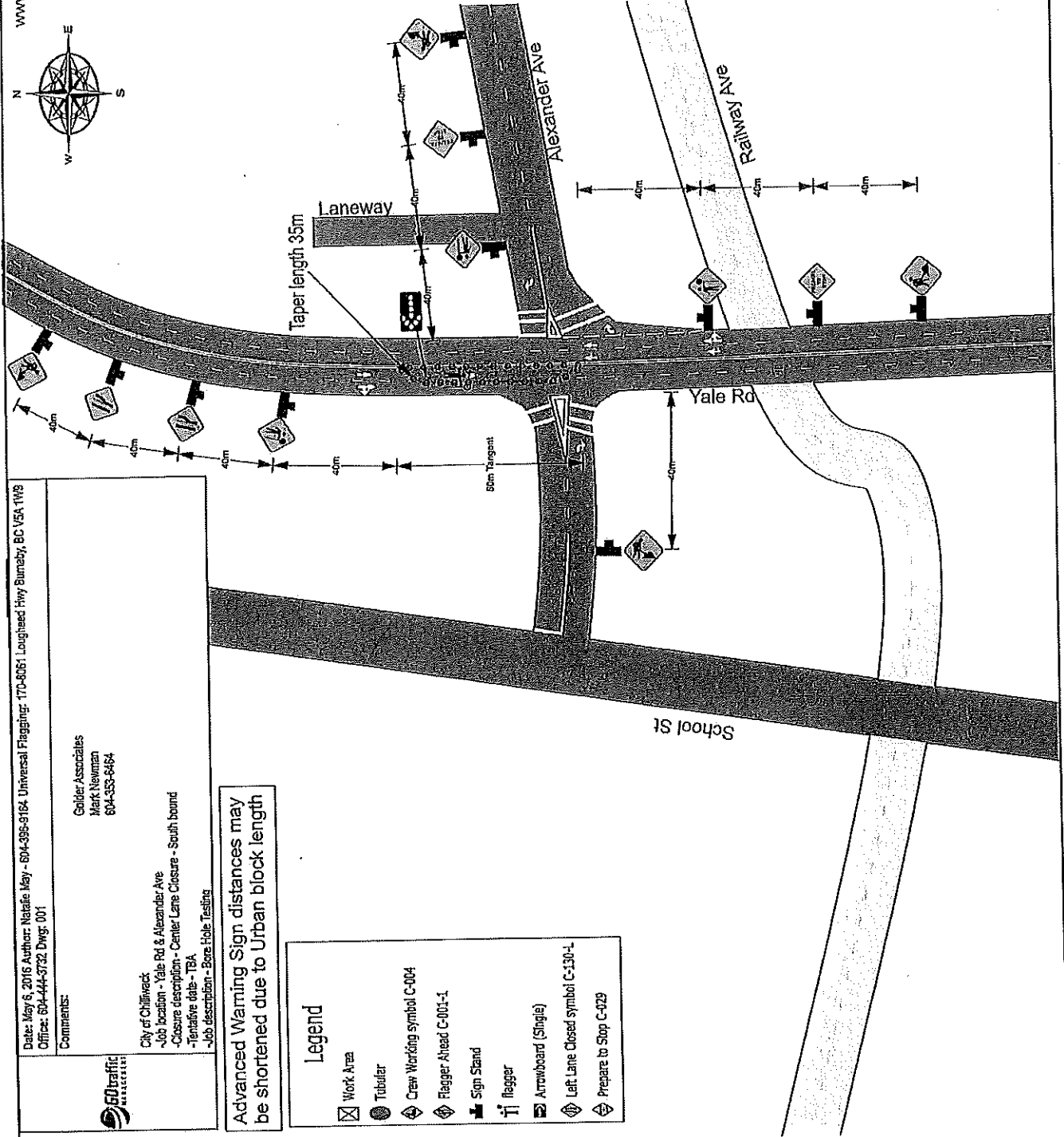
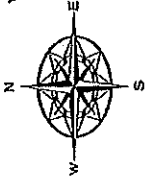

Date: May 6, 2016 Author: Natalie May - 604-396-9164 Universal Flagging: 770-6061 Loughheed Hwy Burnaby, BC V5A 1W8  
 Office: 604-444-3732 Dwg: 001

**Comments:**

Golder Associates  
 Mark Newman  
 604-353-6464

City of Chilliwack  
 -Job location - Yale Rd & Alexander Ave  
 -Closure description - Center Lane Closure - South bound  
 -Tentative date - TBA  
 -Job description - Base Hole Testings

**Advanced Warning Sign distances may be shortened due to Urban block length**

**Legend**

- Work Area
- Tubular
- Crew Working symbol C-004
- Flagger Ahead C-001-1
- Sign Stand
- flagger
- Arrowboard (Single)
- Left Lane Closed symbol C-130-1
- Prepare to Stop C-029